

PARKING LOT AND STREET LIGHTING:

- THE OWNER WILL BE CONTRACTING DIRECTLY WITH DUKE ENERGY FOR THE SUPPLY AND INSTALLATION OF PARKING LOT AND STREET LIGHTING PRIOR TO PLACEMENT OF THE NEW STONE SUBBASE AND ASPHALT PAVEMENT. CONTRACTOR IS REQUIRED TO COORDINATE WITH DUKE ENERGY PROGRESS TO ALLOW THE LIGHTING INSTALLATION AFTER REMOVAL OF THE EXISTING PAVEMENT AND SUBBASE. CONTRACTOR IS RESPONSIBLE FOR THE LIGHT POLE LOCATION STAKE-OUT WHERE SHOWN ON SHEET NO. 22-0322A AND COMPACTION OF THE SITE LIGHTING CONDUIT TRENCH.
- DUKE ENERGY PROGRESS CONTACT:
JAMIE STILL
PHONE: 910-742-8264

PARK BENCHES:

- CONTRACTOR TO INSTALL 8'-4" LONG x 2' WIDE BENCH ON CONCRETE FOOTER (TYP. - 14 PLACES) WITHIN LIMITS OF PARK. CONTRACTOR RESPONSIBLE FOR FOOTER DESIGN AND CONSTRUCTION AND BENCH INSTALLATION. CONTRACTOR TO COORDINATE FINAL BENCH LOCATIONS WITH OWNER. BENCHES TO BE PROVIDED BY OWNER.

ASPHALT PAVEMENT MARKINGS:

- PERRY AVENUE, PERRY AVENUE EXTENSION AND TOWN HALL DRIVE - ALL PAVEMENT MARKINGS TO BE THERMOPLASTIC IN ACCORDANCE WITH THE LATEST EDITION OF THE U.S. DEPARTMENT OF TRANSPORTATION FEDERAL HIGHWAY ADMINISTRATION'S MANUAL ON UNIFORM TRAFFIC CONTROL DEVICES FOR STREETS AND HIGHWAYS (MUTCD). THE ONLY EXCEPTION IS THE PARKING STALL LINES WHICH ARE TO BE WHITE TRAFFIC PAINT. COLOR AND SIZE OF PAVEMENT MARKINGS TO BE AS NOTED ON THESE PLANS AND DETAILS.
- PARK SITE - ALL PAVEMENT MARKINGS TO BE AS NOTED ON THESE PLANS AND DETAILS.

PERRY AVENUE REBUILD:

- WHILE WORKING ON PERRY AVENUE CONTRACTOR MUST MAINTAIN ACCESS TO ALL DRIVEWAYS AT ALL TIMES. CONTRACTOR IS TO NOTIFY LOCAL EMERGENCY (POLICE, FIRE, MEDICAL, ETC.) SCHOOL DISTRICT AND THE GENERAL PUBLIC AT LEAST ONE WEEK PRIOR TO THE START OF CONSTRUCTION ON PERRY AVENUE.
- CONTRACTOR TO REMOVE AND RESET MAILBOXES OUT OF THE CONSTRUCTION LIMITS OF THE PROJECT. NOTIFY THE PROPERTY OWNER PRIOR TO MAILBOX REMOVAL. REINSTALL MAILBOX SAME DAY AS REMOVED IN THE PROPER LOCATION IN REGARD TO THE FINISHED PAVEMENT OF THE PROJECT. MAILBOX HEIGHT MUST BE 41" TO 45" FROM ROAD SURFACE AND MUST BE 6" TO 8" BACK FROM THE EDGE OF THE PAVEMENT. (TYPICAL - 6 PLACES)
- CONTRACTOR TO REMOVE ALL STREET SIGNS IN THE IMMEDIATE WORK AREA AND STORE IN A SAFE LOCATION FOR REUSE. CONTRACTOR TO REINSTALL ALL STREET SIGNS AFTER COMPLETION OF ROAD WORK.

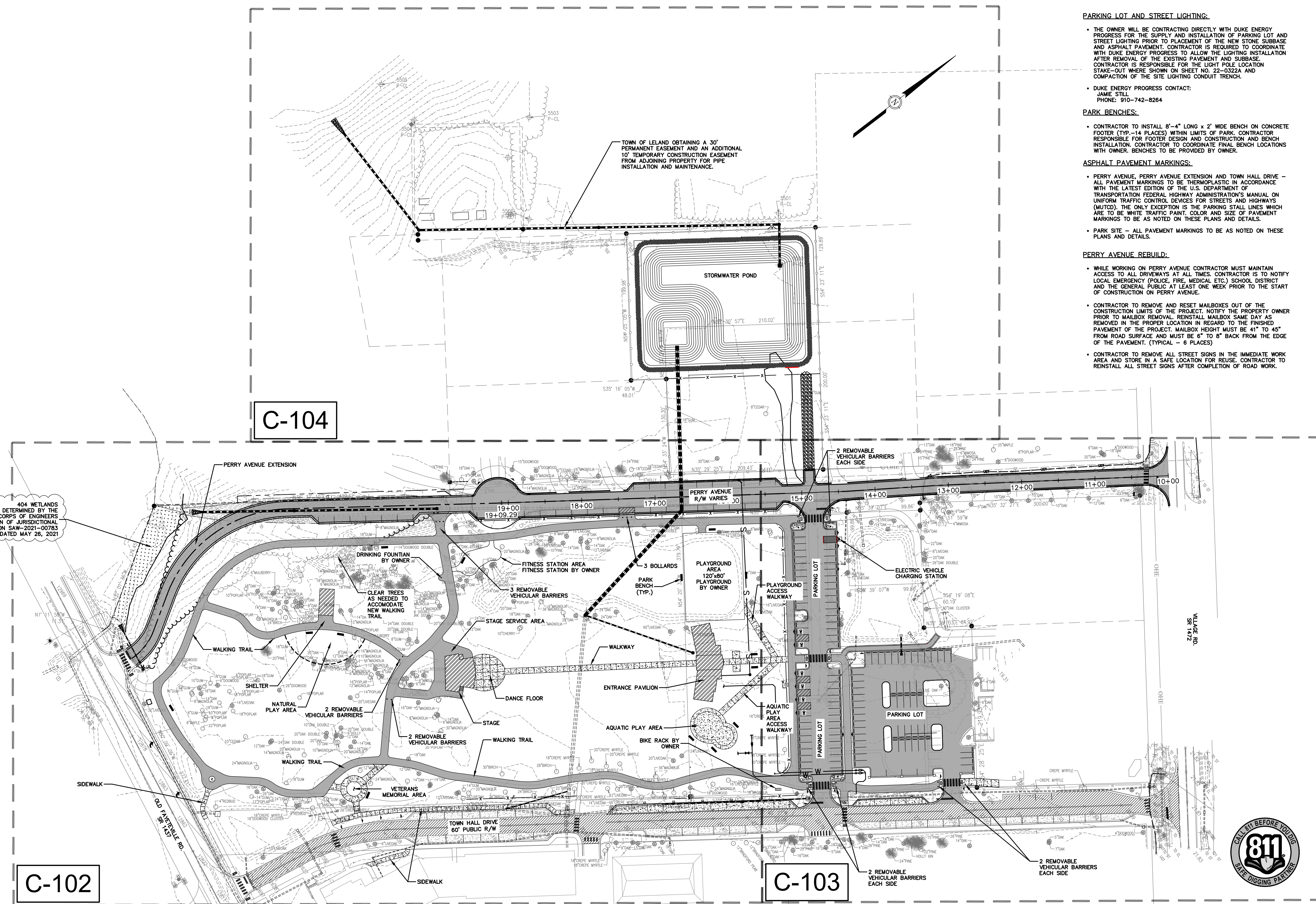

404 WETLANDS AS DETERMINED BY THE US ARMY CORPS OF ENGINEERS NOTIFICATION OF JURISDICTIONAL DETERMINATION SAN-2021-00763 DATED MAY 26, 2021



P:\2021\21.07014\LELAND\FOUNDERS PARK DESIGN\DRAWINGS\PLAN SHEETS\21.07014-C-SITE LAYOUT PLAN_RECOVER.DWG PLOT DATE: 6/23/2023 11:34 AM TONY MINTZ

712 Village Road SW
Suite 103
Shallotte, NC 28470
910.755.5872
NC Firm License # C-0459
mcgillassociates.com

FINAL DRAWING FOR REVIEW PURPOSES ONLY NOT RELEASED FOR CONSTRUCTION

NO.	DATE	BY	DESCRIPTION
1	05/19/23	ADL	IDENTIFICATION OF SURFACE WATERS PER DEQ COMMENTS DATED 5/7/23

LAND DEVELOPMENT PLANS FOR
FOUNDERS PARK RENOVATIONS
TOWN OF LELAND, NORTH CAROLINA

60 0 30 60 120
GRAPHIC SCALE DIVISION VALUE = 60 FEET

OFFICE MANAGER M. NORTON	DESIGNER T. MINTZ
PROJECT MANAGER A. LAPINSKY	REVIEWER A. LAPINSKY

DATE MAY 2023	PROJECT # 21.07014	FUNDING # N/A
------------------	-----------------------	------------------

SHEET
C-101